

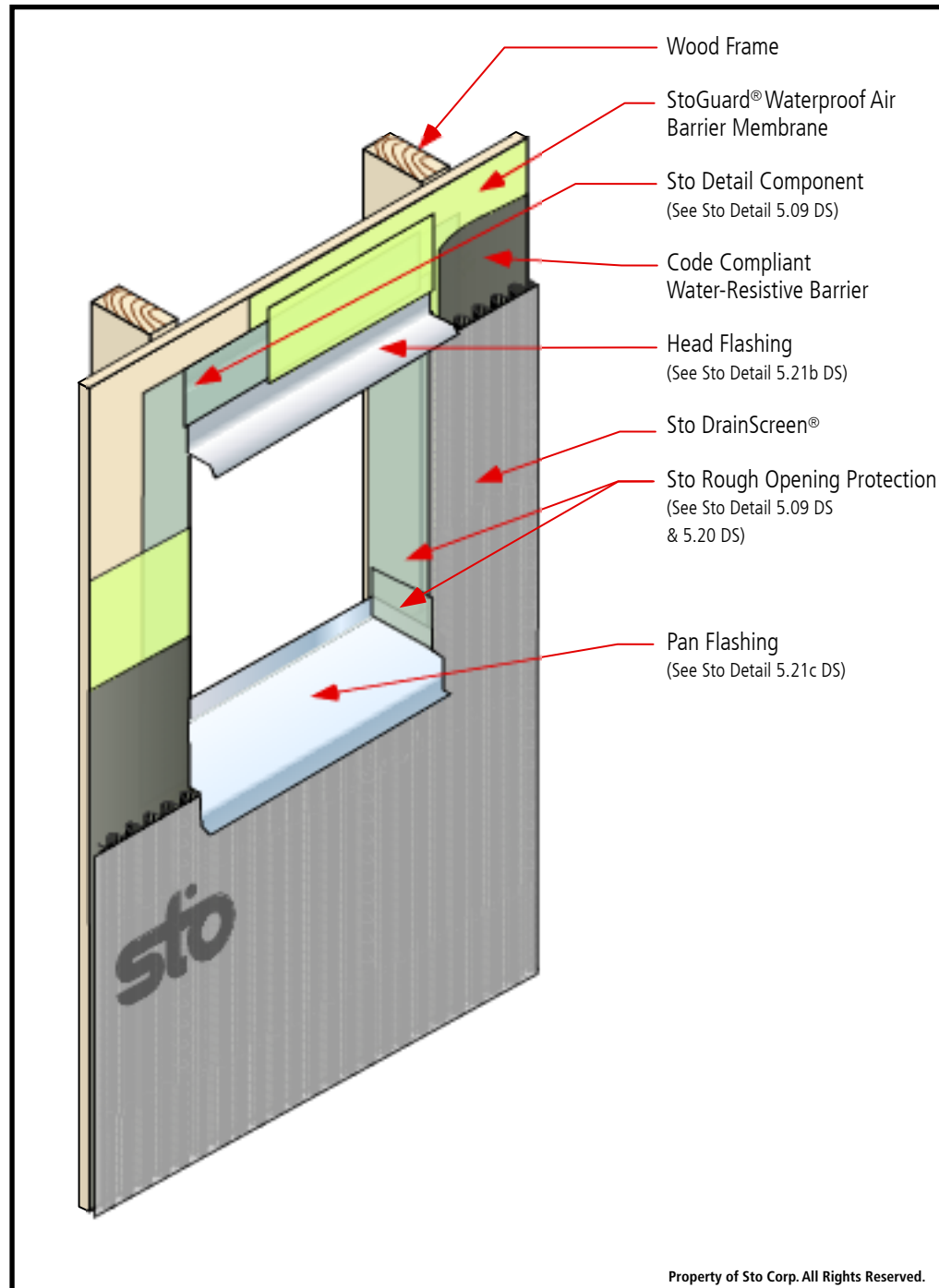

## StoPowerwall® DrainScreen™ Rough Opening Preparation

Detail No.: 5.21a DS

Date: October 2014



### Notes:

1. Prepare opening prior to the installation of the window or mechanical equipment. Coordinate installation with other associated trades.
2. Wrap the rough opening with Sto rough opening protection. Choose from Sto Details:
  - 5.20 M DS
  - 5.20 F DS
  - 5.20 T DS
  - 5.20 R DS
3. Coat the wall surface with StoGuard® Waterproof Air Barrier Membrane
4. Incorporate head flashing as noted in Sto Detail 5.21b
5. For box windows incorporate pan flashing as noted in Sto Detail 5.21c DS
6. For nail-fin windows incorporate sill flashing under the window as noted in Sto Detail 5.21d DS

### Options:

StoGuard® Waterproof Air Barrier Membrane options:

- a. Sto EmeraldCoat®  
(high perm)
- b. StoGuard® VaporSeal™  
(vapor impermeable)

IMPORTANT: Components not identified as Sto are furnished by other manufacturers and are not necessarily installed by trades who install the Sto products. Refer to project specific contract documents.

### ATTENTION

Sto products are intended for use by qualified professional contractors, not consumers, as a component of a larger construction assembly as specified by a qualified design professional, general contractor or builder. They should be installed in accordance with those specifications and Sto's instructions. Sto Corp. disclaims all, and assumes no, liability for on-site inspections, for its products applied improperly, or by unqualified persons or entities, or as part of an improperly designed or constructed building, for the nonperformance of adjacent building components or assemblies, or for other construction activities beyond Sto's control. Improper use of Sto products or use as part of an improperly designed or constructed larger assembly or building may result in serious damage to Sto products, and to the structure of the building or its components.

STO CORP. DISCLAIMS ALL WARRANTIES EXPRESSED OR IMPLIED EXCEPT FOR EXPLICIT LIMITED WRITTEN WARRANTIES ISSUED TO AND ACCEPTED BY BUILDING OWNERS IN ACCORDANCE WITH STO'S WARRANTY PROGRAMS WHICH ARE SUBJECT TO CHANGE FROM TIME TO TIME. For the fullest, most current information on proper application, clean-up, mixing and other specifications and warranties, cautions and disclaimers, please refer to the Sto Corp. website, [www.stocorp.com](http://www.stocorp.com).

[www.stocorp.com](http://www.stocorp.com)